

Installation stages:

1. Raise the insect screen top ahead to the window hole from the inside as in picture 1. Be sure that the plastic pin takes a stand to the outside of the frame.
2. Push the insect screen on its place as in picture 1.
3. Be sure that the insect screen is in right position as in picture 2.

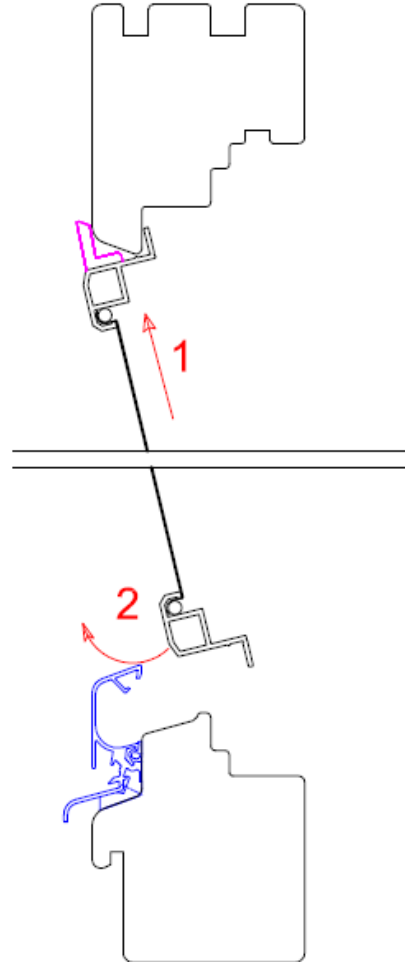

Picture 1. Aluminium insect screen installation to the DK-window. Be sure that the plastic pin takes a stand to the outside of the frame.

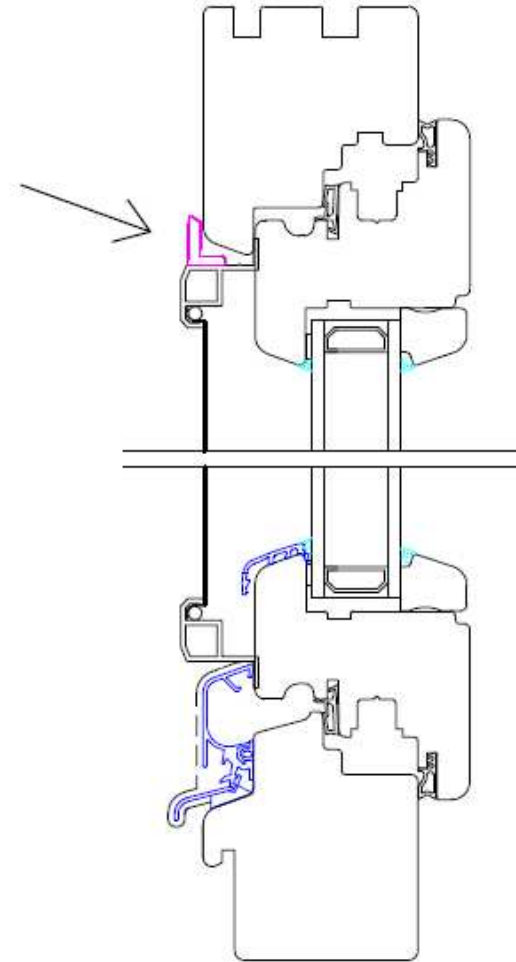

Picture 2. Aluminium insect screen correctly installed.

Manufacturer's instructions (www.solar.fi):

Solar-insect screens has been made by using the weather proof materials. Although, we recommend to remove the insect screens from the windows, outside of the insect-season (e.g. the birds or the weather conditions can cause damages for the nets).