

Dear Customer,

Congratulations for choosing the high-quality products made by Profin. To be able to enjoy the elegant appearance and the reliability of the Profin products, we ask You to note the following instructions for the use and maintenance of the products. **Please familiarize yourself also with the common instructions for receiving, construction-time storing and the usage of the products. Following the maintenance and installation instructions are also a prerequisite for the validity of the guarantee given for our doors.**

Installation

Please, notice that the products will not be installed until the conditions inside the building are correspondent to the final consumption conditions!

It is particularly important for the products' functionality that installation is made carefully. For reaching the best possible final result, we recommend to use professionals for the product installations. The guarantee is not compensating injuries caused by the products' incorrect installation. Never use the products as a supporting structure.

If You need to protect the products, please use only a tape which is suitable for painted surface. Protection time has to be minimized in order to avoid the decaling to cause any damages on the products. Decaling is done always on the client's own responsibility.

Before installing, ensure that the water dripping from the wall will not penetrate behind the architraves or widening boards to the door's installation gaps or to the frame structures. This has to be ensured by using tall enough waterboards above and by sealing the gaps between the architraves and widening boards by using the sealing mass.

Fittings and accessories are packed on the cardboard box, which can be found together with the main products. Depending of the order fittings can be installed already.

Before installation

Check installation opening and fastening points of the frames. Make sure that threshold's base is horizontal ($\pm 0,5$ mm) and stable. Be sure that the installation opening is strong enough. Never use the products as supporting structure. **In log houses it has to attend for reserve enough space for sinking (ensure the issue from the log house supplier).** Otherwise 15 mm isolation margin is enough. Sides have to be strong for installation and at least 15 mm isolation margin. If threshold is too high it is possible to install the door below of the floor level.

To make installation easier take the sliding door leaf off. First open the door and take off the plastic plates from the top of the door. Then put the handle in the up position. Lift the door leaf up and tilt the down sash of the door away from the rail. Then take the door off carefully. Store the door safely and do not damage the sealings. Door leaf will be fasten in the opposite order.

Check the sealings always after installation. Especially the sealings which are below of the sliding door, in order to make sure that the sealings have not been pressed between the door and rail.

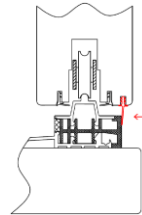

Installation stages

1. Install the insulator underside the threshold. Place the humidity lock on the surface of the concrete. Put the required amount of the assembly wedges underside the installation opening (**picture 1**). The plastic wedges can be found together with the products. Check the threshold's horizontal plane by using the plumb line or the laser indicator.
2. Lift the frame to the installation opening. Be sure that the frame is horizontal (**picture 1**).
3. Drill the holes (5 mm) for the installation screws (**picture 2**), 60 mm from the outer edge and distance between the screws should be about 500 mm.

4. First fasten tentatively one side to the building's frame by using installation screws or in log houses fasten to the well supported T-board. Shore up the fastening points with the assembly wedges.
5. Check the frame's vertical position on the both sides and depth direction by using the spirit level or the laser indicator, regulate if necessary. Then fasten the other side. **Fastening has done always without bending any frames and making sure that the frame corner joints does not open. Additionally ensure that the lower and side frames are installed precisely straight.**
6. At the beginning if you unfastened the sliding door leaf, now it is time fasten again. **Be sure that the sealings are unscathed. Check the lock's functionality (picture 3).**
7. Distance measures between the sliding door and the frame has to be same in underneath, middle and top (**picture 1**). Regulate if necessary.
8. Seal the installation gap between the frame and the wall trunk e.g. by using the mineral glass or fibre wool. We do not recommend using any urethane foam especially not in the log houses, because of the sinking of the wall may cause air leaks and frame warping.
9. Finally install the fittings, architraves, widening boards and necessary mouldings.

The pictures below. Wrong installations!

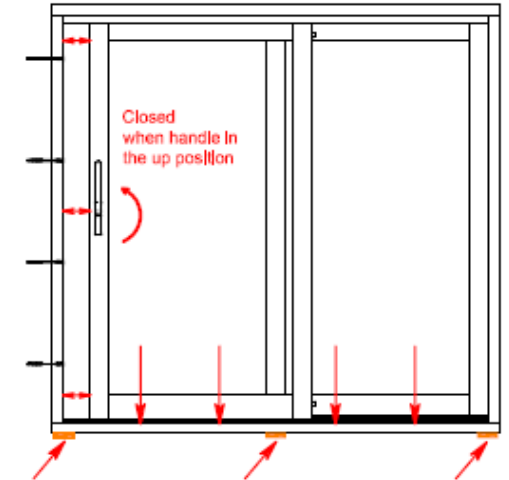
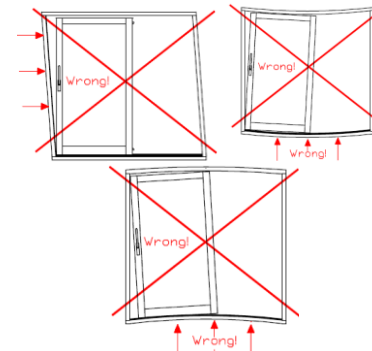

Picture 1. The threshold has to be absolutely horizontal. Use the wedges always in places what you see in picture 1 and maximum distance between the wedges is 0,5 meters.

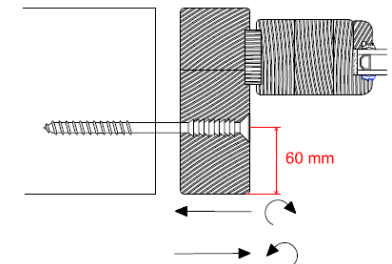

Picture 2. The hole drilling for the screws.

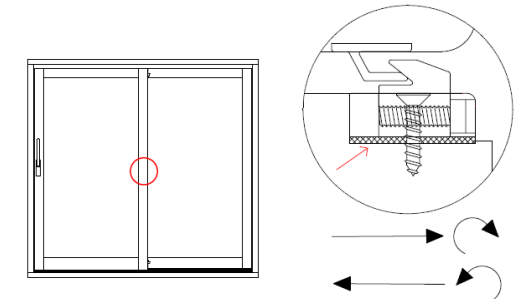

Picture 3. Check that the lock works correctly. Regulate if necessary. Take the sliding door leaf and the plastic plate off if needed.

Usage of the door

Instructions for how to use the handle (picture 1).

Handle up, door is closed.

Handle down, door is open.

Locking releases or turns on when turning the key or knob.

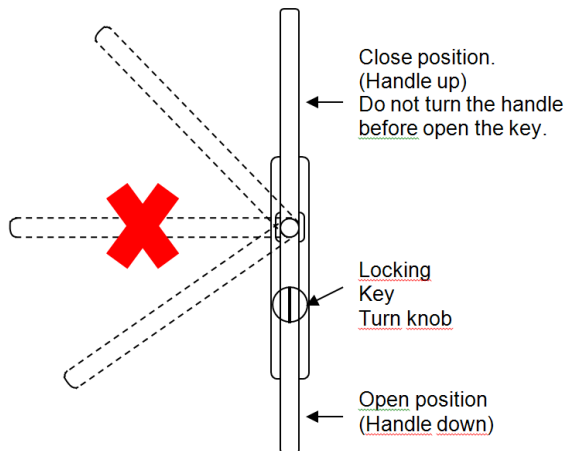

Picture 1. How to use the door handle.

NOTE: If you turn the handle when the door is sliding, the sealings will damage. You have to stop the door always before using the handle.

Safety

Profin has made user-friendly and safe products for You. Please be sure that all users have guided for how to use the sliding door, especially children.

Careless use of the sliding door can cause dangerous situations.

For the safety reasons always lock the sliding door (handle in the position up), because without locking the sliding door-leaf can move.

Maintenance

It is advisable to check and clean the door regularly. This should be done at least twice a year depending on the usage conditions.

Glass surfaces

Clean the glass surfaces when needed. The glass surfaces do not endure strongly alkaline materials, e.g. cement, chaulk and alkaline detergents.

For cleaning the glass surfaces diluted common detergents or special made products for glass surfaces can be used. **Always look after that the washing water so that it will not reach between the glass and wood. This way any damages in the product's structure can be avoided.**

When cleaning coated glass, the cleaning methods have to be verified from the glass manufacturer.

Sashes and frames

It is advisable to check and clean the door and the visible frames approximately every half a year depending on the local conditions. Cleaning can be done with common detergents.

If any damages on the wooden parts' surface treatment are noted, the repair painting operation has to be done immediately. When making the repair painting, wooded parts' humidity percent has to be under 15 %, which can be reached in the summertime.

Instructions for the repair painting:

1. Remove loosen paint, lacquer and wood e.g. with brush.
2. Polish the surfaces which will be painted and remove the grindings carefully.
3. Wash the surfaces which will be painted with the cleansing solution and let it dry (follow the manufacturer's instructions).
4. Treat the visible surfaces with the paint and let it dry.
5. Paint the surfaces for three times with paint suitable for the purpose (outside use only the paints meant for the outside use). Notice, do not paint sealing parts, because they may damage when reacting with the paint.

Sealings and silicone stitchings

Product's sealings and silicone stitchings need to be checked also during the maintenance. Damaged sealings have to be changed for new intact ones to retain the energy efficiency. When necessary, resit the silicone stitchings to retain the water resistance.

The sealings should be treated with silicone at least once a year. The silicone tube can be found with the products. If the sealings make noise, please use then silicone.

Fittings

Fittings have to be remained clean. Cleaning the fittings can be done with common detergents. Mechanical parts have to be oiled e.g. with a lock oil when necessary. Especially handles' mechanical parts need to be oiled regularly.

Notice

The surface treatment will hold its properties approximately for 5 – 15 years depending on the usage conditions. In order to extend the life cycle of the product to its maximum, please repaint when necessary. Note also the environmental effects of dirt, humidity and light conditions.

