

## Dear Customer,

Congratulations for chosen the high-quality products made by Profin. For to be able to enjoy the elegant appearance and reliability of the Profin products, we ask You to note the following instructions for use and maintenance. **Please familiarize also the common instructions for receiving, construction-time storing and the usage of the product. Following the maintenance and installation instructions are also a prerequisite for the validity of the guarantee given for our doors.**

## Installation

**Please, notice that the products will not be installed until the conditions inside the building are corresponding the final consumption conditions!**

It is particular important for the product's functionality that installation is made carefully. For receiving the best possible final result, we recommend to use the professional for product's installation. The guarantee is not compensating injuries caused by the product's incorrect installation. Never use the products as supporting structure. **In log houses it has to attend for reserve enough space for sinking (ensure the issue from the log house supplier).**

If You need to protect the products, please use only the mask which suits for painted surface. Protection time has to minimize, in order the mask do not cause any damages for the products. Masking is done always on client's own responsibility.

Before installing ensure that the water which drips from the wall will not penetrate from behind the architraves or widening boards to the door's installation spaces or to the frame structures. This has to ensure by using enough tall waterboard above and by sealing the spaces between the architraves and widening boards by using the sealing mass.

## Installation stages

1. Check installation opening and fastening points of the frames.
2. Put the required amount of assembly wedges underside the installation opening. Put the wedges also under the midframes. We recommend to use the installation screws. Isolation margin of the frame and installation opening has to be all over the place at least 10 mm.
3. For to make installation easier loose the sash from the frame.
4. Lift the frame to the installation opening.
5. Check the threshold's horizontal plane by using the spirit level or the laser indicator.
6. Install the frame and fasten tentatively frame's hinge side to the building's frame. Check the cross measurements, the frame's vertical position on both side and depth direction by using the spirit level or the laser indicator (**picture 1**), regulate if necessary.
7. Lift the sash on it's place and test the window's function, regulate if necessary.
8. Fasten the frame's lockside on the same way as hinge side. Test the window's function and fasten the frames conclusive. Windows which are wider than 1,2 metres, it is also good to fasten the up frame (not in log houses). **Notice**, in log houses fasten the frames to the well supported T-boards. **See installation options in the pictures 2,3 and 4 (drill 5 mm holes for the installation screws). Fastening has to be done always without bending any frames and making sure that the frame corner joints do not open. Additionally ensure that the lower and side frames are installed precisely straight.**
9. Seal the installation gap between the frame and the wall trunk e.g. by using the mineral- glass- or fibre wool. We do not recommend to use any urethane foam especially not in the log houses, because of the sinking of the wall may cause air leaks and frame warping.
10. Finally install the fittings, architraves and widening boards.

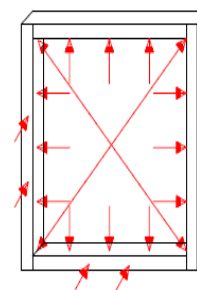

**Picture 1.** Window's perpendicular, cross measurement and rabet measurement checking points, during and before the installation.

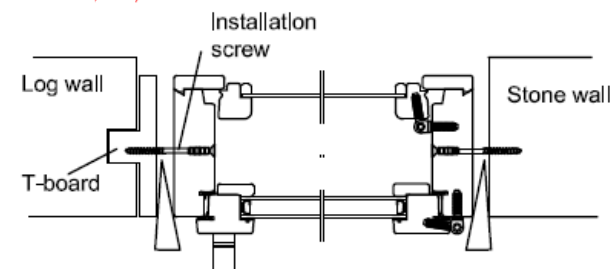

**Picture 2.** The opening window installation to the T-board or stone wall.

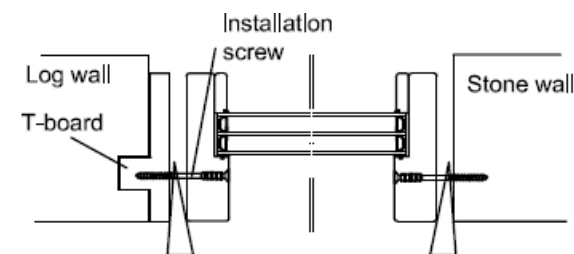

**Picture 3.** The fix window installation to the T-board or stone wall.

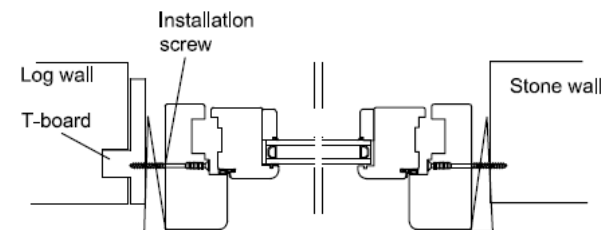

**Picture 4.** TT, TH, TS and TS -window installation to the T-board or stone wall.

## Adjustment instructions

You can adjust the position of window's gait gaps by turning sashes forks or ferrules to clockwise or counterclockwise (picture 1).

- First, take off the locking pins and take the sash off.
- If the sash is too far from the frame, turn the fork (1) to clockwise, or counterclockwise, if it is too close.
- Window's gait gaps on sideways can be adjusted by turning the ferrules (2) clockwise or counterclockwise, if they are too far away.

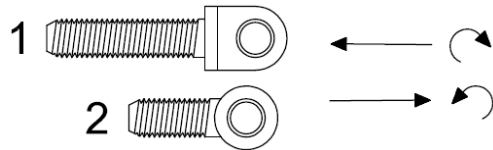

**Picture 1.** Fork-(1) and ferrule-part (2) adjusting.

## Maintenance of the window

It is advisable to check and clean the windows regularly. At least twice a year, depending on the usage conditions.

### Glass surfaces

Clean the glass surfaces when needed. The glass surfaces do not endure strongly alkaline materials, e.g. cement, chalk and alkaline detergents.

For cleaning the glass surfaces can use dilute common detergents or special made products for glass surfaces. **Always look after that the washing water do not reach between the glass and wood. By this way can be avoid causing any damages in the product's structure.**

**When cleaning the coating glasses it has to ensure the cleaning methods from the glass manufacturer.**

### Door and frames

It is advisable to check and clean the door and the visible frames approximately every half a year, depending on the local conditions. Cleaning can be done with the common detergents.

**If noticing any damages on wooden part's surface treatment, repair painting operation has to be done immediately.** When making the repair painting, wood part's humidity percent has to be under 15 %, which can be reach in summertime.

## Instruction for repair painting:

1. Remove loosen paint, lacquer and wood e.g. with brush.
2. Polish the point which will be painted and remove the grindings carefully.
3. Wash the surfaces which will be painted with the cleansing solution and let it dry (follow the manufacturer's instructions).
4. Treat the visible surfaces with the paint and let it dry.
5. Paint the surfaces with paint which is suited for the purpose for 3 times (use outside only the paints ment for outside use). Notice, do not paint sealing parts, because they may damage when reacting with the paint.

## Sealings and silicone stitchings

Product's sealings and silicone stitchings need to check also during the maintenance. Damaged sealings has to change for the new intact ones, because of retaining the energy efficiency. When necessary resit the silicone stitchings for retaining the waterproof.

## Fittings

Fittings has to retain clean. Cleaning the fittings can be done with the common detergents. Mechanical parts has to oil e.g. with the lock oil when necessary. Especially handle's mechanical parts need to be oiled regularly.

## Notice

The surface treatment solutions will hold their properties, depending on the usage conditions, approximately for 5 – 15 years. In order to extend the life cycle of the product to the maximum, please repaint when necessary. Note also the environmental issues which are caused by dirt, humidity and light conditions.